

Rx-D

USER INSTRUCTIONS



FEATURES

- Digital Radio
- Pulse & Visual Replication
- Multiple Range Settings
- Easy Pairing
- RunLite Mode
- DND (Do Not Disturb)
- Advanced Security (Patented)
- Adjustable Vibro Mode
- Recall Last Activity
- Power on Indicator
- Enhanced Power Saving

OPERATION SUMMARY

- 1.0 CONTROLS
- 2.0 FIT BATTERY
- 3.0 SWITCHING ON/OFF
- 4.0 EASY PAIRING
- 5.0 FACTORY DEFAULT SETTINGS
- 6.0 RANGE SETTINGS
- 7.0 VIBRO
- 8.0 RECALL
- 9.0 ANTI-THEFT SECURITY
- 10.0 RUNLITE
- 11.0 DND (DO NOT DISTURB)
- 12.0 WARNINGS & ALERTS
- 13.0 WIRELESS RADIO USE
- 14.0 GUARANTEE & CARE GUIDELINES

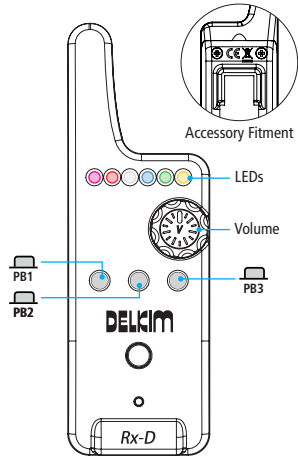

1.0 CONTROLS

- 1.1 PUSH BUTTONS - PB1, 2 & 3 (left to right) – **Important** – Button presses are acknowledged by various intuitive confirmation tones and LED flashes.
- 1.2 VOLUME CONTROL (V) – Turn clockwise to increase level.
- 1.3 ACCESSORY FITMENT – Fitting for Lanyard, Bankstick and Belt Clips.

IMPORTANT – BEFORE fitting a battery to the Rx-D read the Easy Pairing Instructions 4.0 – 4.4.

WARNING – Do not look directly at the LEDs or have the local speaker volume turned up to maximum when connecting a battery or switching on.



2.0 FIT BATTERY

Do NOT use rechargeable batteries. Use a good quality 9 volt battery such as a Duracell PP3. Completely REMOVE the two screws using the tool provided. Slightly lift the top of the battery cover and slide down. DO NOT USE FORCE. Attach battery and re-fit cover by sliding upwards and clicking into place. Replace the screws being careful not to over tighten.

Note – When a battery is connected to an unpaired Rx-D or it is switched ON manually (see 3.0) the Purple LED will flash continuously indicating waiting for Easy Pairing. Easy Pairing must be commenced within 45 seconds or the Rx-D will switch itself OFF automatically.

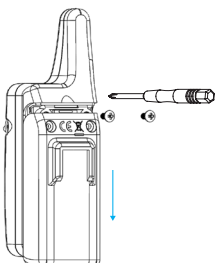

3.0 SWITCHING ON/OFF

The Rx-D requires a three push button press to switch ON/OFF. Hold down PB1+2+3 together until confirmation tones are heard and immediately release.

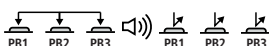

- 3.1 ON INDICATOR – The last channel activated LED blinks every 2 minutes to indicate that the Rx-D is switched on.

INSTRUCTIONS KEY GUIDE

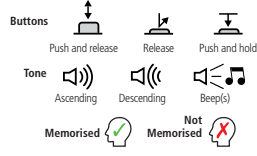

4.0 EASY PAIRING

Before the Rx-D can be used wirelessly it must first be paired with the users uniquely coded Txi-Ds. Use Single Channel Pairing to pair Txi-Ds with the preferred Rx-D channel LED colour. Use Multi-Channel Pairing to pair up to 4 Txi-Ds with one Rx-D channel LED colour differentiated visually by 1-4 flashes.

- 4.1 HOW TO PAIR – First ensure that the Rx-D & Txi-Ds to be paired are all switched OFF. Set Responses to a low level and Volumes to medium. **Important** – The Rx-D will switch itself OFF automatically with nothing memorised if at any stage of Easy Pairing there is a delay of more than 45 seconds or if Easy Pairing is not completed. If an error is made before Pairing Completion switch OFF manually or wait for automatic switch OFF. Recommence Easy Pairing.



- 4.2 SINGLE CHANNEL PAIRING – Switch the Rx-D ON. The Purple LED flashes continuously indicating Single Channel Pairing Mode. If the Purple Channel is to be paired, switch ON the first Txi-D within a metre of the Rx-D to transmit the code.

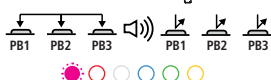

If the Purple Channel is not to be paired, press and release PB1 until the required channel LED flashes and switch on the appropriate Txi-D. When the code is accepted, it is confirmed audibly and the next channel LED will start flashing.



Note – The Rx-D will only allow pairing with one unique Txi-D code at a time. Any further transmissions of the same code will result in an audible error message. Continue pairing as required and complete by pressing and releasing PB1 through all LED channels (including Yellow) until Pairing Completion is confirmed.

- 4.3 MULTI-CHANNEL PAIRING – Proceed as 4.1 & 4.2 but once the Purple LED is flashing press and hold PB1 for one beep followed by two beeps and release. The Purple LED will flash continuously accompanied by single beeps indicating Multi-Channel Pairing request.

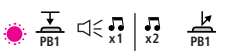

If the Purple Channel is not to be paired, press and release PB1 until the required channel LED flashes and switch ON the appropriate Txi-D. When the required channel is reached pair each Txi-D in turn as 4.2. Unlike 4.2 when each Txi-D code is accepted the same channel LED will continue to flash until all the required Txi-Ds are paired. Continue pairing as required and complete by pressing and releasing PB1 through all LED channels (including Yellow) until Pairing Completion is confirmed.



- 4.4 CHECK PAIRING – Activate or switch ON each Txi-D to ensure that they are paired correctly with the Rx-D. Pairing errors can only be corrected using MEMCLEAR (4.5). The Rx-D receiver is now ready to use and will replicate everything from paired Txi-Ds audibly and visually. Once pairing is complete the Security Default is set to ON and if a Txi-D is switched OFF it will trigger the Anti-Theft Alarm. It can be silenced instantly by pressing any PB on the Rx-D (See 9.2).

- 4.5 MEMCLEAR – Clears pairing memory. This must be carried out in order to pair replacement/additional Txi-D(s) or to correct any pairing errors. Switch ON keeping all three PBs held down until two beeps are heard then immediately release. Press and hold PB3 until the Rx-D switches OFF. This clears the memory completely. To pair again simply repeat Easy Pairing (4.0 – 4.5).

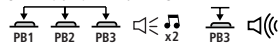

5.0 FACTORY DEFAULT SETTINGS

When switched ON after pairing completion.

RANGE	STANDARD
VIBRO	ON
SECURITY ALARM	ON
RUNLITE	OFF
DND	OFF

6.0 RANGE SETTINGS

The Factory Default is Standard Range with user selectable Boost or Short Range. Standard Range (up to 750M) will cover most situations and give excellent battery life. Boost will give extra range (+15%) for 15 minutes. Short Range (up to 50M) is a special in-swing setting that will maximise battery life whilst the user is close to their Txi-Ds.

Note – The range figures quoted are maximum line of sight measurements. Actual range should always be checked using the Txi-D Range Test and will depend entirely on ambient and bankside conditions. See Txi-D user guide (section 11.0).

Warning – Delkim will not be responsible for the use of our products in contravention of any fishery or radio regulations.

- 6.1 CHANGE RANGE – Press and hold PB1 to cycle through the range settings. Short - Standard - Boost. Release PB1 as soon as the selected range is reached. **Note** – Range settings are not memorised - Range always resets to Standard after switch OFF.



- 6.2 BOOST TIMEOUT – After 15 minutes Boost times out with audible warning and restores the previously set range either Standard or Short. **Excessive use of Range Boost may reduce battery life.**

- 6.3 VERIFY RANGE SETTING – Press and release PB1 and the Range LEDs will illuminate.



7.0 VIBRO

Factory Default is ON with one repeat. Press and release PB2 to toggle between ON/OFF. **Memorised setting.**



- 7.1 CONFIGURE VIBRO REPEATS – The number of repeats may be changed from the Factory Default 1 to 2 or 3 as required. Press PB2 to switch vibro OFF then press and hold PB2 to change number of repeats to 1, 2 or 3 releasing at required setting. **Memorised setting.**



8.0 RECALL

Press and hold PB3 – Last LED illuminates as long as button is held down. Pressing PB3 may also be used as a quick Rx-D ON/OFF status check.



9.0 ANTI-THEFT SECURITY ALARM

The Factory Default is ON. When triggered by the Txi-D switch OFF or the IMU sensor (if enabled) the Security Alarm will sound continuously for 20 seconds.

- 9.1 SECURITY ON/OFF – Press and release PB1 + PB3 to toggle between ON/OFF. **Note** – Turning SECURITY OFF is for the session ONLY. It automatically defaults back to ON whenever the Rx-D is switched OFF.



- 9.2 SECURITY ALARM ABORT – If alarm has been triggered press any PB to abort (Rx-D remains switched ON after Security Alarm Abort). **Note** – To avoid accidental triggering always switch Rx-D OFF before Txi-Ds.

10.0 RUNLITE

All 6 LEDs illuminate together to provide emergency illumination for 15 seconds when triggered by continual beeps for 4 seconds. The activated channel LED stays ON for a further 4 seconds. Press and release PB1 + PB2 to toggle between ON/OFF. Pressing any PB whilst the LEDs are illuminated turns them OFF until RunLite is triggered again. **Session only setting not memorised.**

Note – Constant activation of RunLite will reduce battery life.



11.0 DND (DO NOT DISTURB)

An emergency setting that prevents the Rx-D from sounding until 4 seconds of continuous activations have been received. Stops unwanted indications from a sudden change in conditions such as a shower of hailstones. Times out automatically after 15 minutes. Press and release PB2 + PB3 to toggle between ON/OFF. **Not memorised.**



- 11.1 DND LOCK – Locks DND ON continually and can be used to deliberately stop the user from being disturbed by anything other than a full blooded run. Use with great care and NOT when snag fishing. To set press and hold PB2 + PB3 until the "locked" pip is heard. **Session only setting not memorised.**

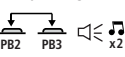

- 11.2 RUNLITE + DND may be both set together – See 10.0 & 11.0.

12.0 WARNINGS & ALERTS

- 12.1 BATTERY CONDITION – The battery condition is tested at switch ON and after each activation. If it is found to be low it gives a distinctive triple descending tone warning. Replace the battery as soon as possible. If the Rx-D battery drops below a certain level WITHOUT any activation it gives repeated battery fail warnings and must be replaced immediately. Replacing a battery – Disconnect the battery and press all PBs for 2 seconds. Fit the replacement battery and the Rx-D will switch ON automatically. **Replacing a battery does not affect anything memorised.**

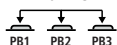

Note – Low battery warnings are also received from the Txi-Ds indicating individually which one has the low battery.

- 12.2 AUTO SWITCH OFF (Power Saving) – When switched ON if no activity is detected from a paired Txi-D within approximately 48 hours the Rx-D will switch OFF with an audible confirmation countdown warning. Press any PB to extend for another 48 hours.

- 12.3 PB FAILSAFE ABORT – If all or any PBs become held down continuously by accident the Rx-D will assume a fault state and switch OFF automatically.

13.0 WIRELESS RADIO USE

Keep the Rx-D at least half a metre away from all electrical devices and the Txi-Ds.

14.0 GUARANTEE & CARE GUIDELINES

Rx-D comes with a 2 year guarantee as standard (3 years with registration). The Rx-D does not need servicing. Look after it and it will look after you.

- After use in rain clean and store in a warm place to dry with the hard case removed.
 - If an Rx-D becomes immersed in water, switch OFF, remove the battery and shake out any water. Store in a warm place to totally dry out.
 - Tampering with any screws other than to remove the battery door or treating with any substance particularly WD40 will invalidate any guarantee.
- Full terms and conditions of our guarantee, registration, after sales care and best practice can be found on our website. www.delkim.co.uk

EXTENDED 3 YEAR WARRANTY REGISTRATION



All Delkim products come with a 2 year guarantee as standard but we do offer an extended 3 year warranty if you register online.

You will need to follow the instructions and provide your proof of purchase. The extended warranty starts from the date of purchase not the date of registration.

To register go to www.delkim.co.uk/registration

The EU Declaration of Conformity for the Rx-D can be viewed on our website www.delkim.co.uk/DOC



Delkim Ltd., P.O. Box 270, Bedford, England MK43 7DZ

Tel. +44 (0) 1234 721116

Fax +44 (0) 1234 721148

www.delkim.co.uk

